

Note:

- (1) All dimensions are in meters unless otherwise specified.
- (2) No dimension to be scaled from drawing

For tender purpose only

Client



Consultant



Project title

Development of economic zone - Mongla, Bangladesh

Drawing title

Finished Road Levels (FRL) of access road

Drawing no :	Rev no :
	0

Scale :

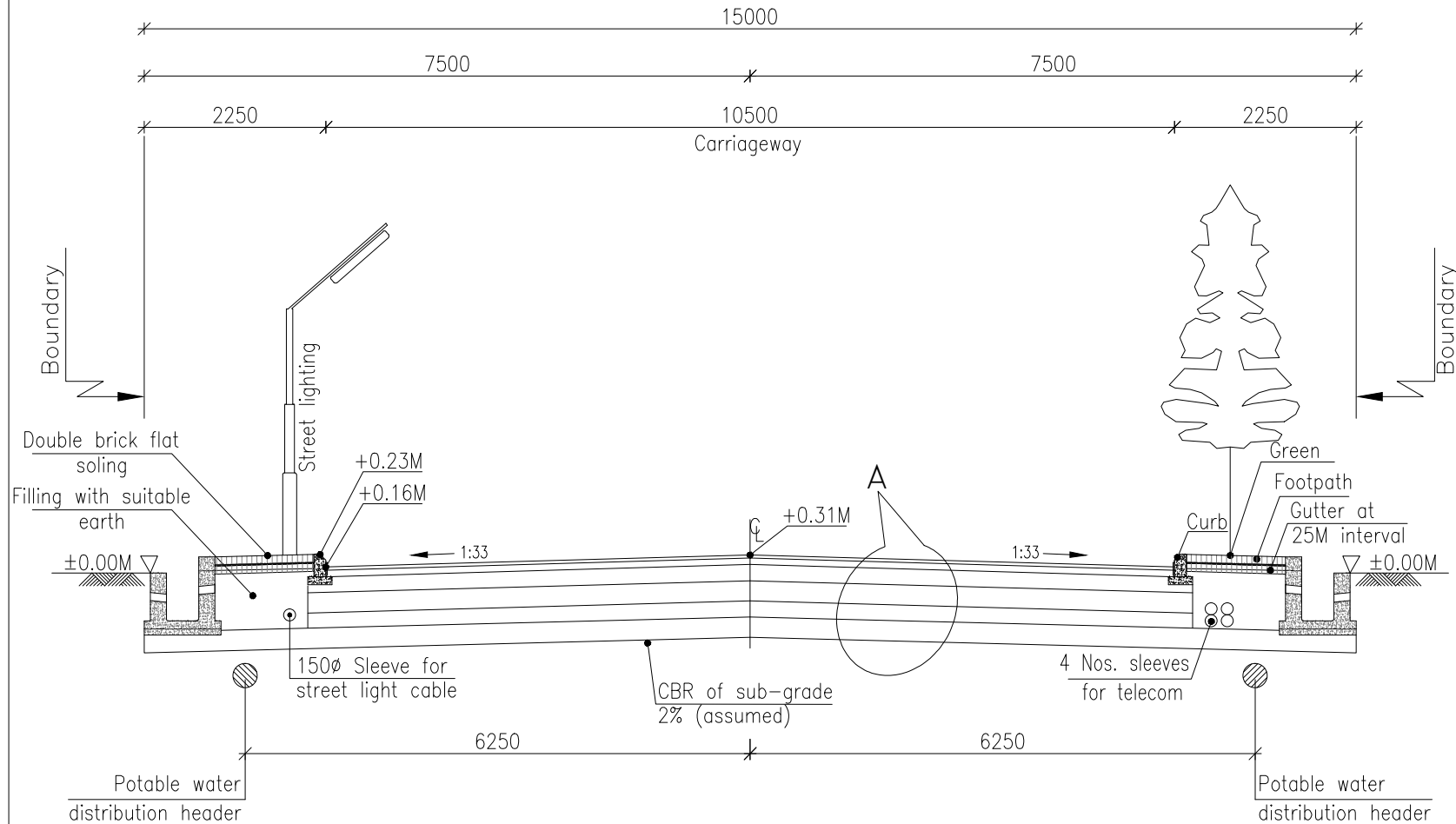

TYPICAL CROSS SECTION OF ROAD (15.00M)

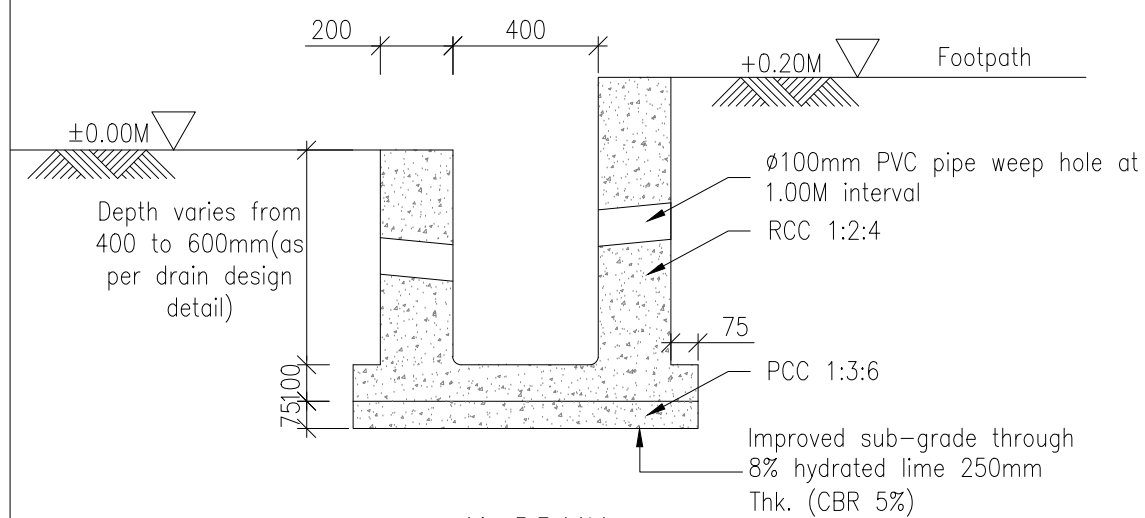

U-DRAIN

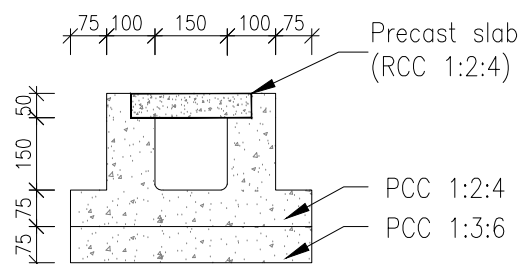

GUTTER AT 25M INTERVAL

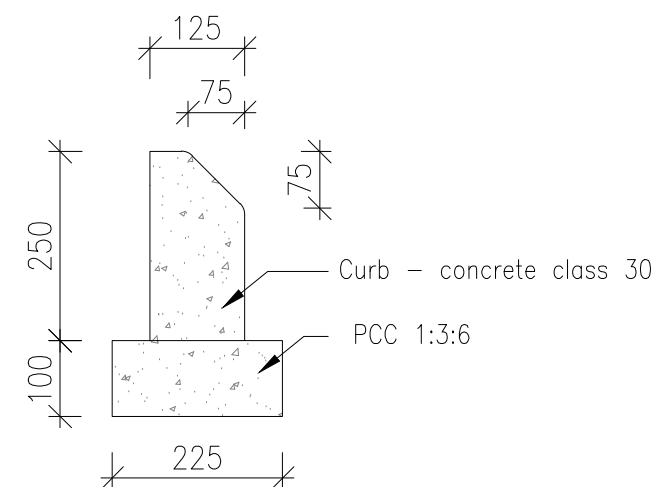

Curb

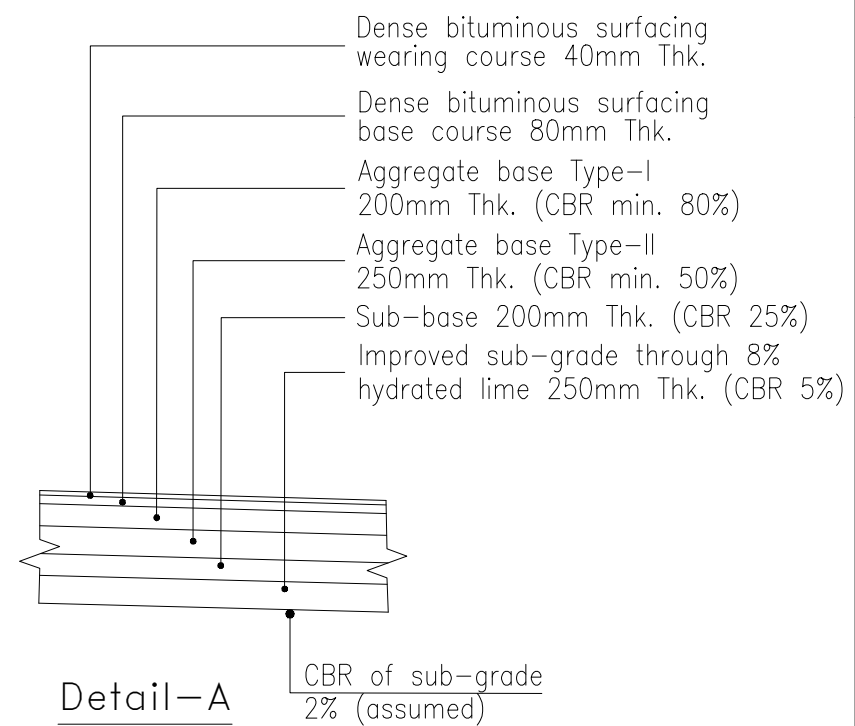

Detail-A

Note:

- (1) All dimensions are in millimeters unless otherwise specified.
- (2) No dimension to be scaled from drawing

For tender purpose only

Client



Consultant



Mahindra
Consulting Engineers



Project title

Development of economic zone - Mongla, Bangladesh

Drawing title

Typical cross section of Access road

Drawing no :

Rev no :

0

Scale :

NOTE:

- 1) The sub-grade shall be tested for CBR value.
- 2) The improved sub-grade through 8% hydrated lime thickness of 250mm is considered, assuming the CBR value of sub-grade as 2%
- 3) The improved sub-grade thickness shall be adjusted based on the actual CBR value of sub-grade obtained from test and the table below recommends the thickness of improved sub-grade for various CBR value as per the Roads & highways department design guide.

CBR required	Compacted thickness of additional layer to provide			
	CBR of underlying layer			
	2%	3%	4%	5%
5%	250mm	150mm	100mm	---

- 4) In all cases sub grade material with a CBR of less than 2% should be removed and replaced with fill material complying with section 2.6 of RHD specifications.